



DigiFarm Quick Reference Card

Android - IOS

Android Quick Reference Card

Note: Not all android devices function the same; please try your device before purchasing. DigiFarm's John Deere Solution is NOT supported on all android devices.

Step 1: Pair the Beacon with android device (fig. 1)

Step 2: Download DigiFarm NTRIP Client app, open it, and select the gear in the top right corner (fig. 2)

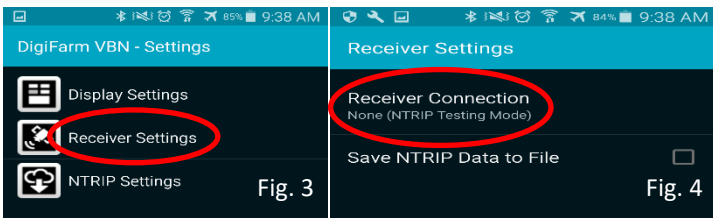
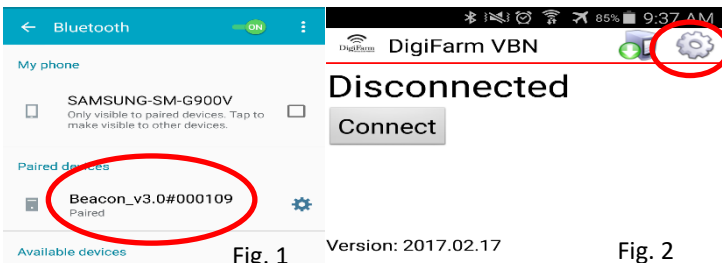

Step 3: Select receiver settings (fig. 3); then receiver connection (fig. 4); External via Bluetooth (fig. 5); then choose Bluetooth device (fig. 6); check auto-enable Bluetooth box (fig. 7)

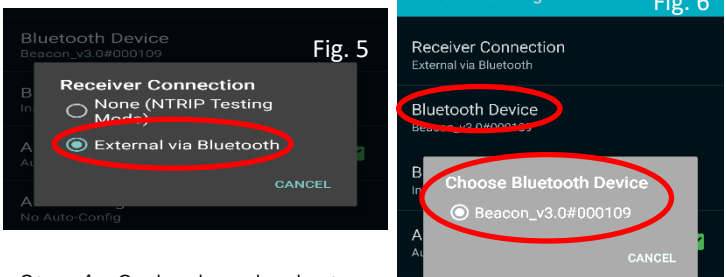

Step 4: Go back and select NTRIP Settings (Fig. 8); Network protocol NTRIP v1.0, Caster Port 3101, your username, and password from DigiFarm; download source table; and get from external receiver (fig. 9)

Step 5: Return to the home screen of the app and tap Connect; a list of mountpoints will appear for you to select the correct one; once selected, the app will start automatically

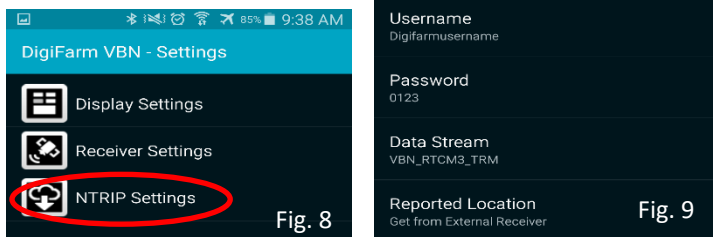

IOS Quick Reference Card

Step 1: Pair the Beacon with the IOS device via the settings app (Figs. 1 & 2)

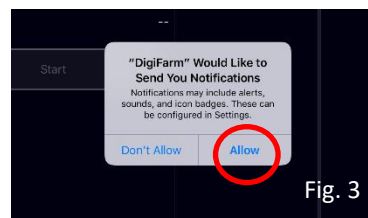
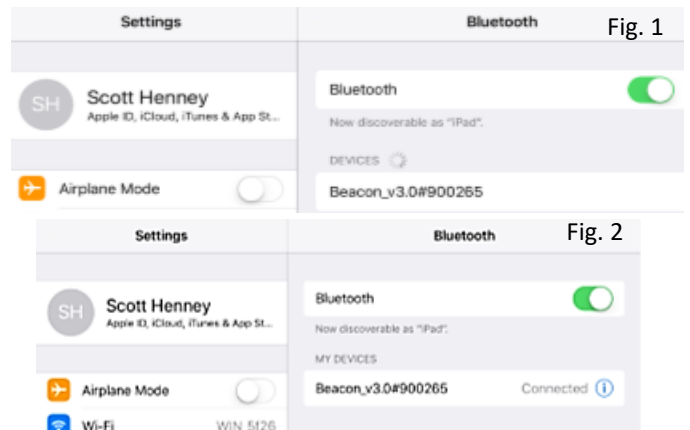

Step 2: Download the DigiFarm NTRIP Client app and allow notifications (Fig. 3)

Step 3: Confirm Beacon connection within the app (Fig. 4); select your receiver type (Fig. 4); and enter your username and password (Fig. 5)

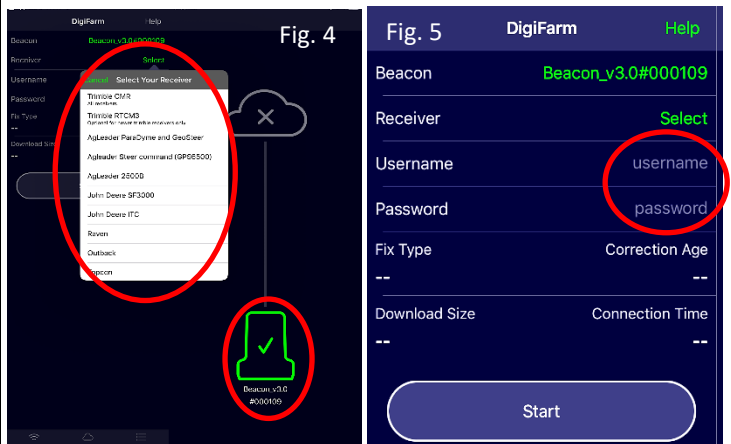

Step 4: Tap the green Start button; you will be prompted to allow location access. Allow location (Fig. 6); and you will start streaming RTK data (Fig. 7)

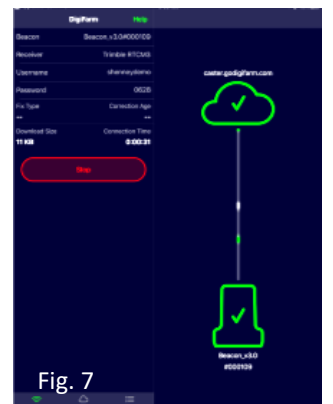
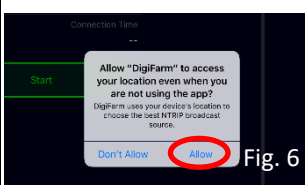

DigiFarm Technical Support
319.531.7574
support@godigifarm.com